

SINCE-1990



COSTARICA
HOMES & DEVELOPERS

- Offering a mesmerizing ambiance -

GREEN VALLEY

- In the heart of nature's beauty -

15 FARM HOUSE | RESORT | RESTAURANT | CLUBHOUSE

A photograph of a modern, multi-story house at night. The house features large windows and balconies with glass railings, illuminated from within. A tall palm tree stands to the right of the house. The sky is dark and cloudy. The image is framed by a thin gold border.

ABOUT **COMPANY**

Established in the year 1990 Costarica Homes and Developers is a real estate development company dedicated to creating exceptional properties that define the real estate industry.

As we say, Where Dreams Come True. At Costarica Homes and Developers our dedicated team is here to help you realize your dreams.

Walk in with a vision, and watch it become reality. We build homes with more than just bricks and cement, we build with trust. We forge strong, lasting relationships with our customers by staying committed to our promises. It's your journey, and we're here to guide you every step of the way.



ABOUT THE PROJECT

GREEN VALLEY Project is an exciting development currently under construction, designed to blend seamlessly with its picturesque natural surroundings. Set in a serene and elevated location, this project promises to offer an idyllic retreat, combining modern living with rustic charm.

The design focuses on creating a harmonious balance between nature and architecture, with spacious interiors and expansive outdoor spaces that make the most of the breathtaking panoramic views of the surrounding hills. Whether it's for a peaceful getaway or a family home, this farmhouse will soon stand as a testament to sustainable living, offering comfort and peace in the heart of nature's beauty.

Artist's Impression



Artist's Impression

GRAND ENTRANCE GATE

Welcome to a Grand Entrance Amidst Nature

Step through an elegant main gate, seamlessly blending with the lush greenery around it. A perfect harmony of sophistication and nature, this entrance sets the tone for a serene and luxurious living experience.





Artist's Impression

FARMHOUSE

1200sqft Luxurious Farmhouse

Set in a peaceful 12-acre retreat, this farmhouse features a double-height living room, an elegant drawing room, and three spacious bedrooms with an open-concept toilet design. A modern open kitchen and an open staircase leading to the first floor complete this stylish and comfortable home.





Artist's Impression





GROUND FLOOR PLAN

INTERIOR



A sleek and modern farmhouse interior featuring a stunning double-height living area that opens up to expansive views of lush greenery. Large sliding doors seamlessly connect the indoors with nature, flooding the space with natural light. The design combines minimalist elegance with warmth, creating a tranquil, airy atmosphere that invites the beauty of the outdoors inside.



Artist's Impression



FIRST FLOOR PLAN



SITE PLAN

CLUB HOUSE

Exclusive Clubhouse – A Hub of Luxury & Leisure

Experience world-class amenities in our premium clubhouse, designed for relaxation, fitness, and entertainment. Enjoy a refreshing swimming pool, a state-of-the-art gym, and dedicated spaces like a kids' zone and game zone for endless fun. Host meetings in the conference room, conduct business in the meeting room, or celebrate in the elegant banquet hall. Unwind at the restaurant & bar, making every moment a perfect blend of comfort and indulgence.

**“Where Luxury Meets Nature –
Your Perfect Retreat”**



Artist's Impression



“Featuring a pristine swimming pool embraced by lush greenery”

“Escape to Elegance”



“Unwinding by the water, socializing with loved ones, or simply embracing nature’s serenity—this is your ideal escape for leisure and luxury.”



Swimming Pool & Waterfall

Enjoy the refreshing swimming pool with a calming waterfall, surrounded by nature. The perfect spot to relax, unwind, and escape.

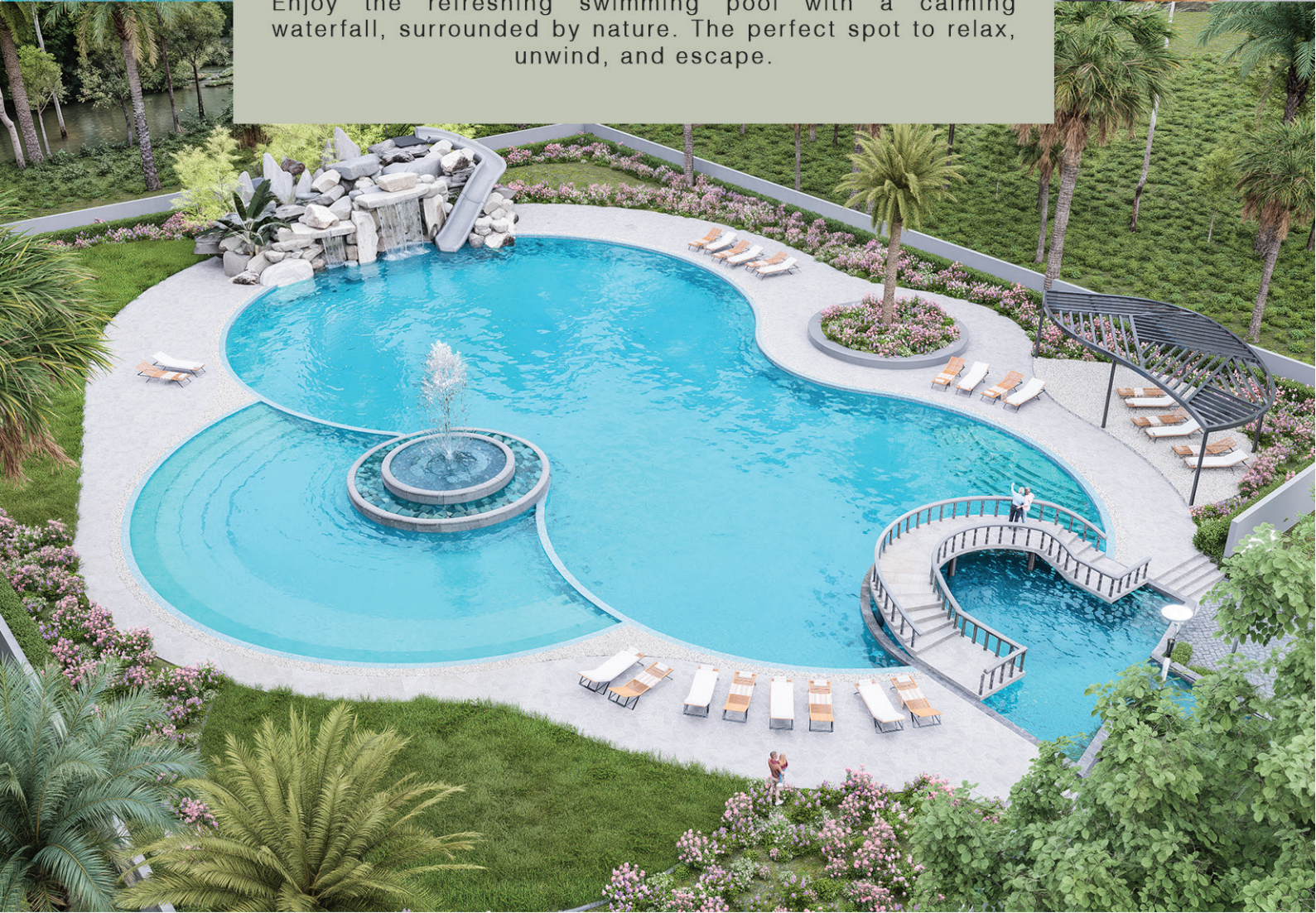

AMENITIES

Jharkhand's 1st vacation Home's / Farm House Project With
luxurious Amenities -:



1. Swimming Pool



2. Artfully designed waterfall



3. Banquet & Restaurant with 50 valet parking



4. Yoga & meditation spaces



5. Cricket Turf & Tennis court



6. Children park



7. Patios & barbeque



8. 24 hrs Security Service with CCTV



9. Guest car parking



10. Solar lights



11. Temple



MEDITATION AREA



KIDS PLAY AREA



YOGA AREA



CRICKET TURF



BADMINTON COURT



TENNIS COURT



GREEN VALLEY

Contact Now: 9264452278, 9264452280,



COSTA RICA HOMES AND DEVELOPER

— Since 1990 —

WHERE DREAM COMES TRUE

Office Address

E/3 2nd floor, Contractors Area, Bistupur, Jamshedpur-831001

Site Address

Green Valley, Rudia
1 km from NH 33, near chandil checkpost

Website

<https://www.costaricahomesdeveloper.co>



Disclaimer: The photographs and furniture used are an artist's impressions for illustration purposes only and may not bear resemblance to the actual feature / offerings. This is not intended to create any legal obligation on any party. This only describes the concept of the project. The images and details mentioned in this document are tentative and subject to change/variation, addition/alterations at the sole discretion of the Promoter, architect and/or appropriate authorities or as may be made by the Promoter keeping in mind extant/proposed laws, rules and regulations. The plans, specifications, images and other details herein are only indicative and the Promoter reserves its right to change any or all of these in its/their own discretion subject to grant of approval from concerned authorities. This brochure does not constitute an offer, an invitation or an offer and/or commitment of any nature by and between the Promoter and the recipients. No furniture is provided with the apartments as depicted herein. The dimensions of chargeable area have been rounded off to the next two digits after decimal and are merely indicative and not final. Marginal revision in dimensions may be necessary during construction as per the directive of the concerned authorities and/or the architects